

**Curb Inlet System:**

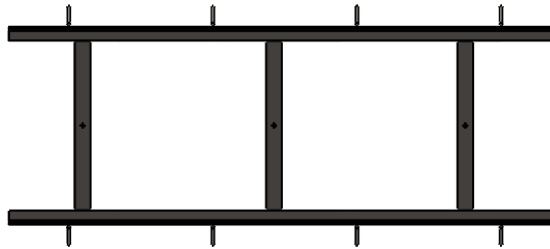

Curb Inlet Casting



Curb Inlet E-Frame

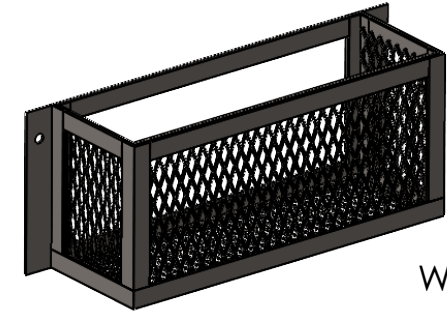

Curb Inlet Waste Basket (Optional)

**Section A:** Grate Design (Select One)



Divisadero HP

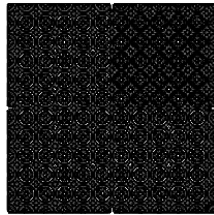

Interlaken

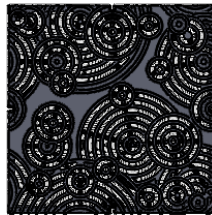

Oblio



Rain HP

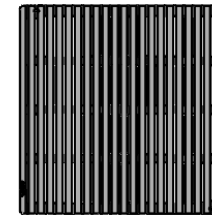

Regular Joe HP

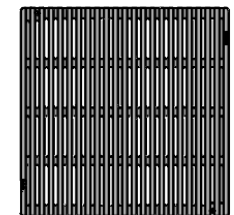

Regular Joe

**Section B:** End Condition (Select One)

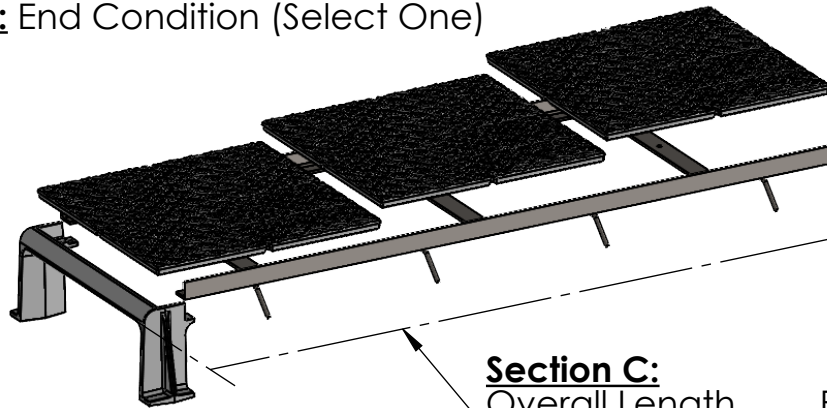

No End Condition This End (Standard)

Second Curb Inlet "Book End" (Optional)

Waste Basket (Optional)

**Section C:**  
Overall Length \_\_\_\_\_ Feet \_\_\_\_\_ Inches

**NOTES:**

1. Select Grate Design from **Section A**.
2. Specify Desired End Condition from **Section B**.
3. Provide Overall Length in **Section C**.

Made in USA ©2023 Iron Age Designs

**24" Curb Inlet System - Worksheet**

<p><b>IRON AGE DESIGNS</b> Telephone 206.276.0925 www.ironagegrates.com</p>	Material: Mild Steel/Ductile Iron	Weight: N/A lbs.	Free Drain Area: N/A in/sq., or N/A %	By: MS	Checked: MS	Date: 4-3-24
	Finish: Raw	Edge: Variable	Flow Rate: N/A GPM, or N/A CuFt./sec.	© Registration: Pending	Scale: NTS	
	Fits: 24" Curb Embedments	Product ID: N/A	Drawing Name: 01_24"_CurbInlet_System_Default			